

**W. HARRIS SURVEYS LTD
NEWFOUNDLAND LAND SURVEYORS**

**P.O. Box 142
Bonavista, NL
A0C 1B0**

**Phone No. 468-7482
Fax No. 468-7482**

DESCRIPTION

All that piece or parcel of land situate and being at Port Rexton, in the Electoral District of Trinity North, in the Province of Newfoundland and Labrador, Canada, abutted and bounded as follows, that is to say:

Beginning at a point in the northeastern limit of Level Road, the said point having NAD 83 Co-ordinates of N5 362 235.120 metres and E280 237.660 metres of the Modified 3° Transverse Mercator Grid Projection for the Province of Newfoundland.

THENCE running by land of Albert King (Roll 1514, Frame 42) north forty eight degrees thirty five minutes zero seconds east eighty two decimal one seven zero metres.

THENCE running along the southwestern limit of a Reservation, ten metres wide, along Little Pond to a point having a bearing and distance of south thirty six degrees fifty five minutes fifty one seconds east forty one decimal eight four two metres from the previously described point.

THENCE running by land claimed by Shirley Porter south forty seven degrees fifty nine minutes fifty one seconds west seventy eight decimal six nine seven metres.

THENCE running along the said northeastern limit of Level Road north forty one degrees forty one minutes thirty seconds west forty two decimal five one nine metres, more or less, to the point of beginning.

CONTAINING an area of 0.337 hectares, more or less, and being more particularly shown and delineated on the diagram annexed hereto.

All bearings being referred to Grid North of the above mentioned Projection.

RESERVING NEVERTHELESS from the above described piece or parcel of land a NL power transmission line easement, fifteen metres wide extending through southwestern portion and is as shown on the diagram annexed hereto.



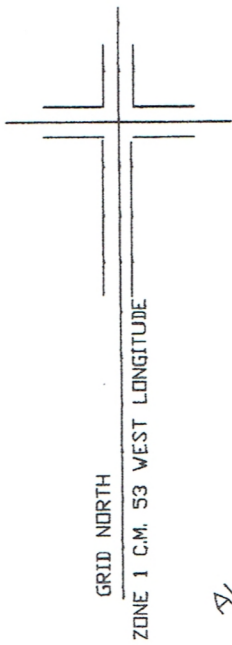

ALBERT KING
ROLL 1514, FRAME 42

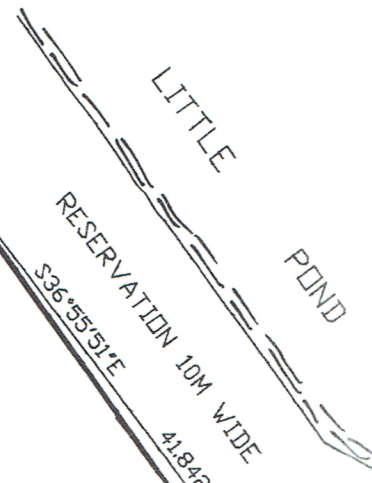

REMAINS OF OLD FENCE
82.170

0.337 HA.

N5 362 235.120
E280 237.660

POLE

NL POWER TRANSMISSION LINE
15.00M WIDE

S47°59'51"W 78.697

LEVEL ROAD
N41°14'14"N 42.519

CLAIMED BY
SHIRLEY PORTER

LEGEND

- | | | |
|---------------------|-------|--------|
| IRON PIN | ————— | ○ |
| EXISTING IRON PIN | ——— | E.I.P. |
| CONTROL MON. | ————— | △ |
| PROPERTY DEALT WITH | ————— | ○ |
| FENCE LINES | ————— | —x— |
| CAPPED IRON PIN | ————— | ⊙ |

CO-ORDINATES BASED ON NAD 83
SCALE FACTOR USED IS

THIS PLAN AND THE ACCOMPANYING DESCRIPTION OF
W. HARRIS SURVEYS LTD. FORM AN INTEGRAL PART OF THE
WHOLE AND ARE NOT SEPARABLE.

© WINSTON HARRIS, NEWFOUNDLAND LAND SURVEYOR 2018
UNAUTHORIZED USE, ALTERATION OR REPRODUCTION OF
THIS SURVEY PLAN AND DESCRIPTION IS PROHIBITED

REFERENCE MONUMENTS